

# Lee Chapel

Ulemj Enkhbold, Ryan Grant, Nicole Porter, Hollis Tardy

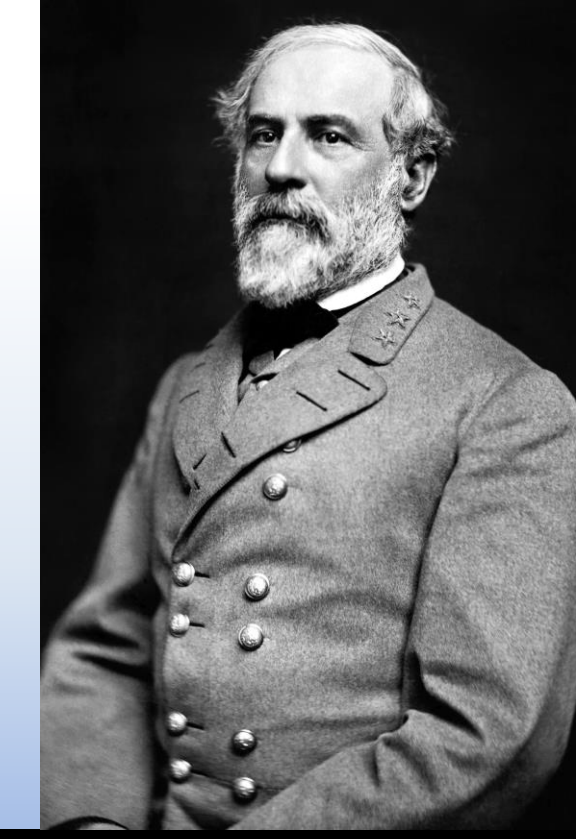

## Motivation

We want to inform the public about the history of Lee Chapel through the use of digital visualizations



Robert E. Lee's funeral procession

## Research Questions

Overarching Question

- What is the progression of Lee Chapel's purpose from its construction to the 1920's?

Supporting Questions:

- What was Lee's family's perception of the proposed renovations in the 1920's?
- How would the renovations have altered the Washington and Lee campus?

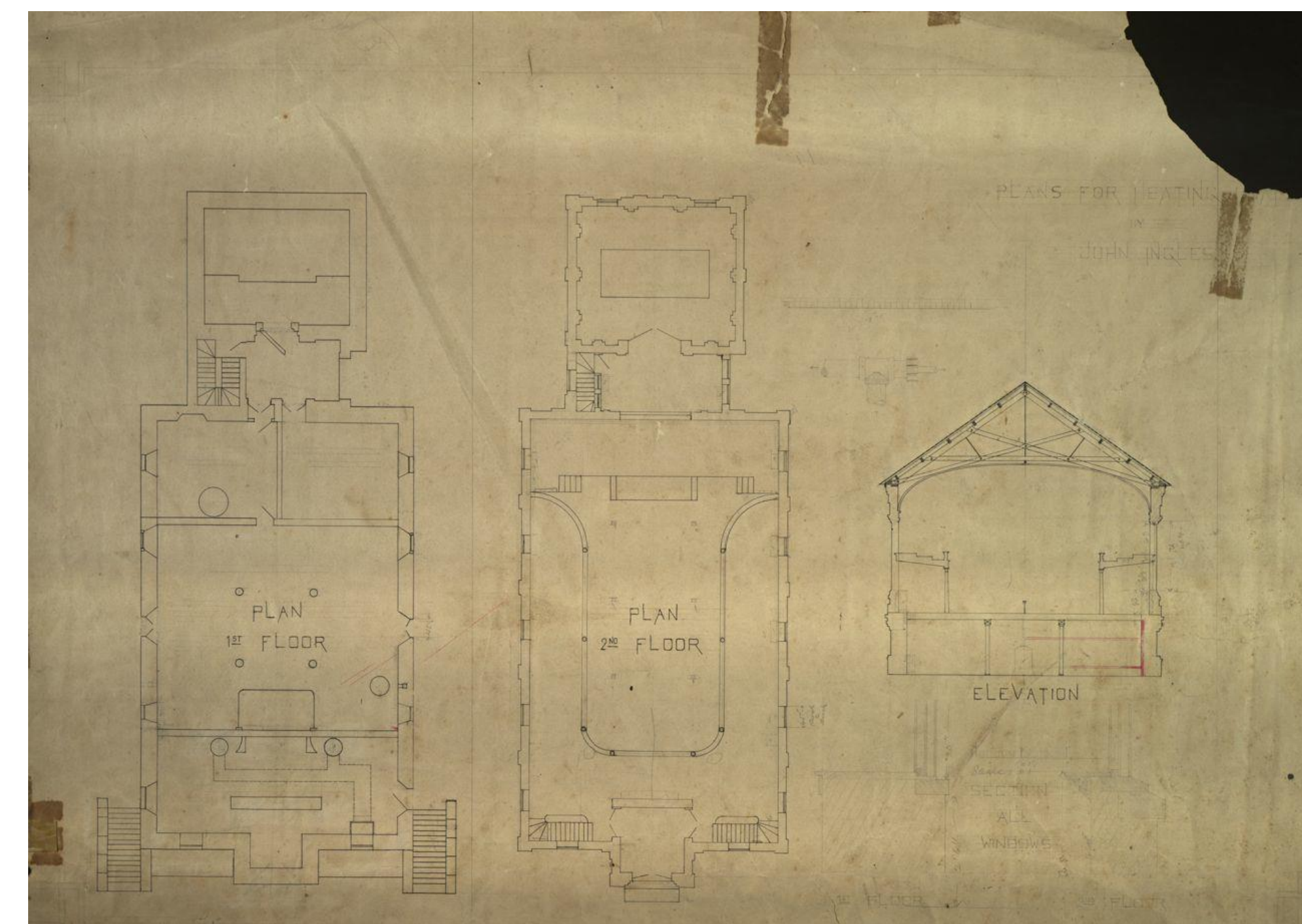

Original Chapel blueprints

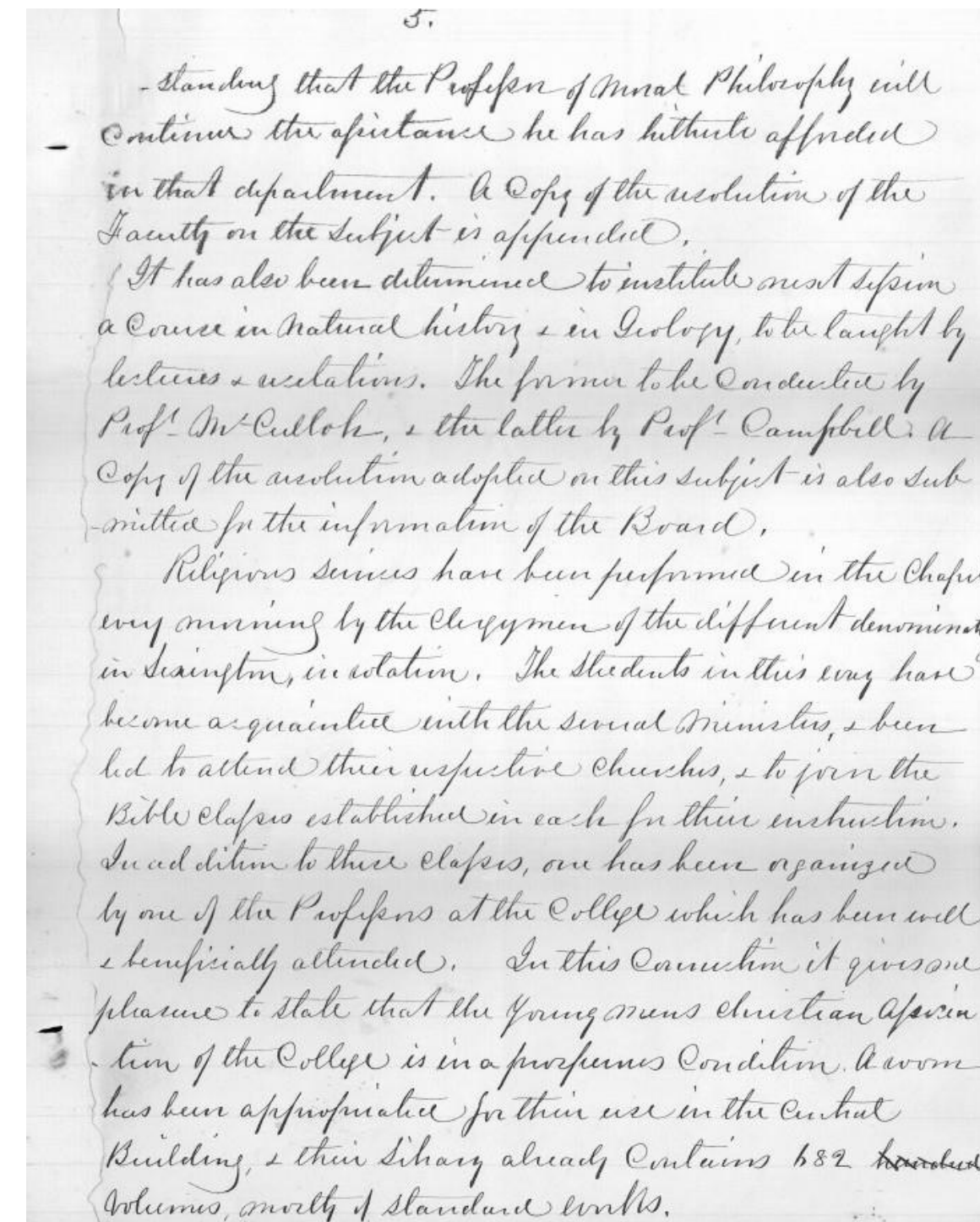

Robert E. Lee's letter of request to construct Lee Chapel

## Methodology

Photographs

Timeline

Letters and Correspondence

Blueprints and Sketches

3D models

Social Media Launch



Lee Chapel 1910-1911

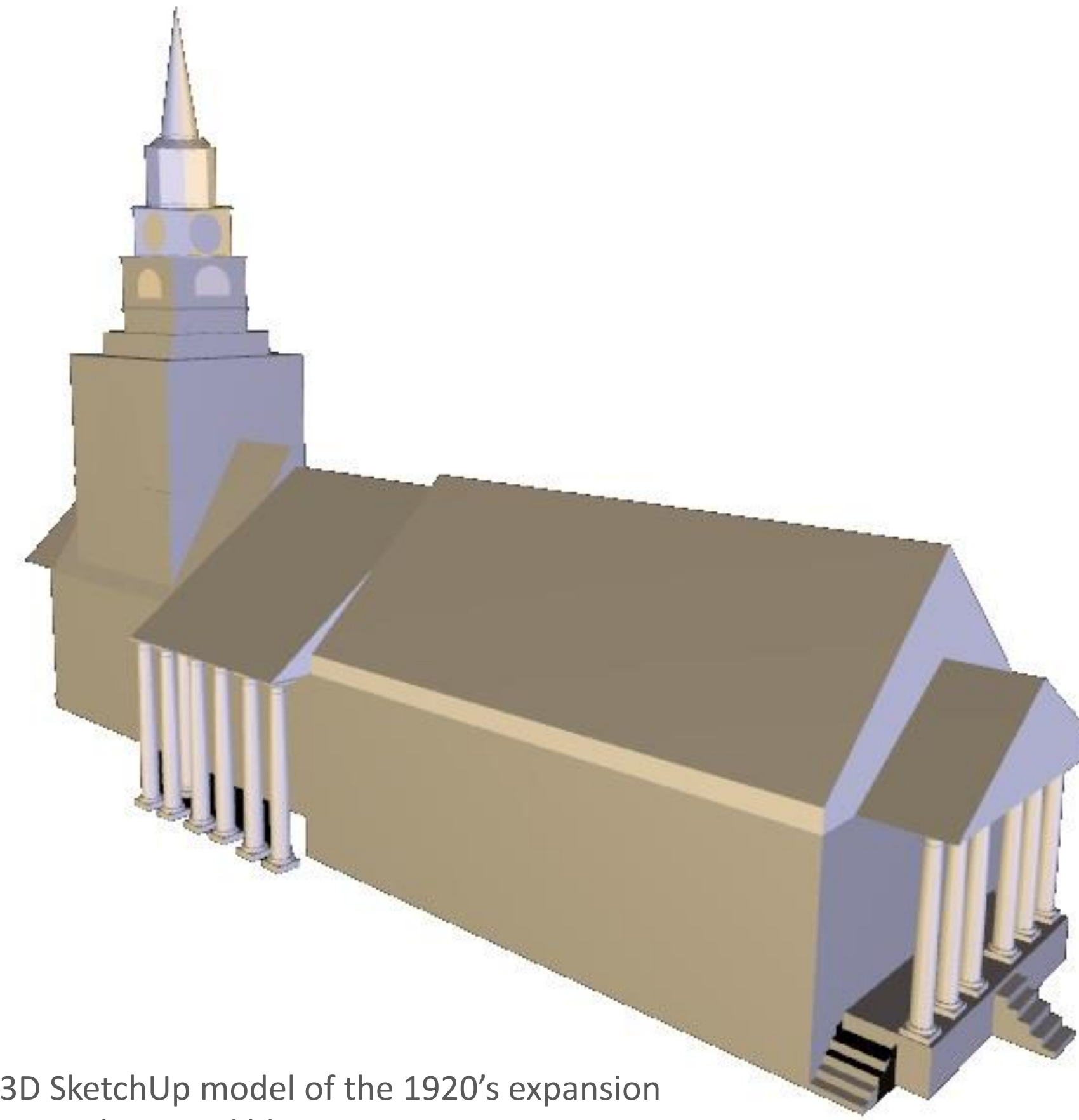

3D SketchUp model of the 1920's expansion using the actual blueprints



3D model of Recumbent Lee currently in Lee Chapel

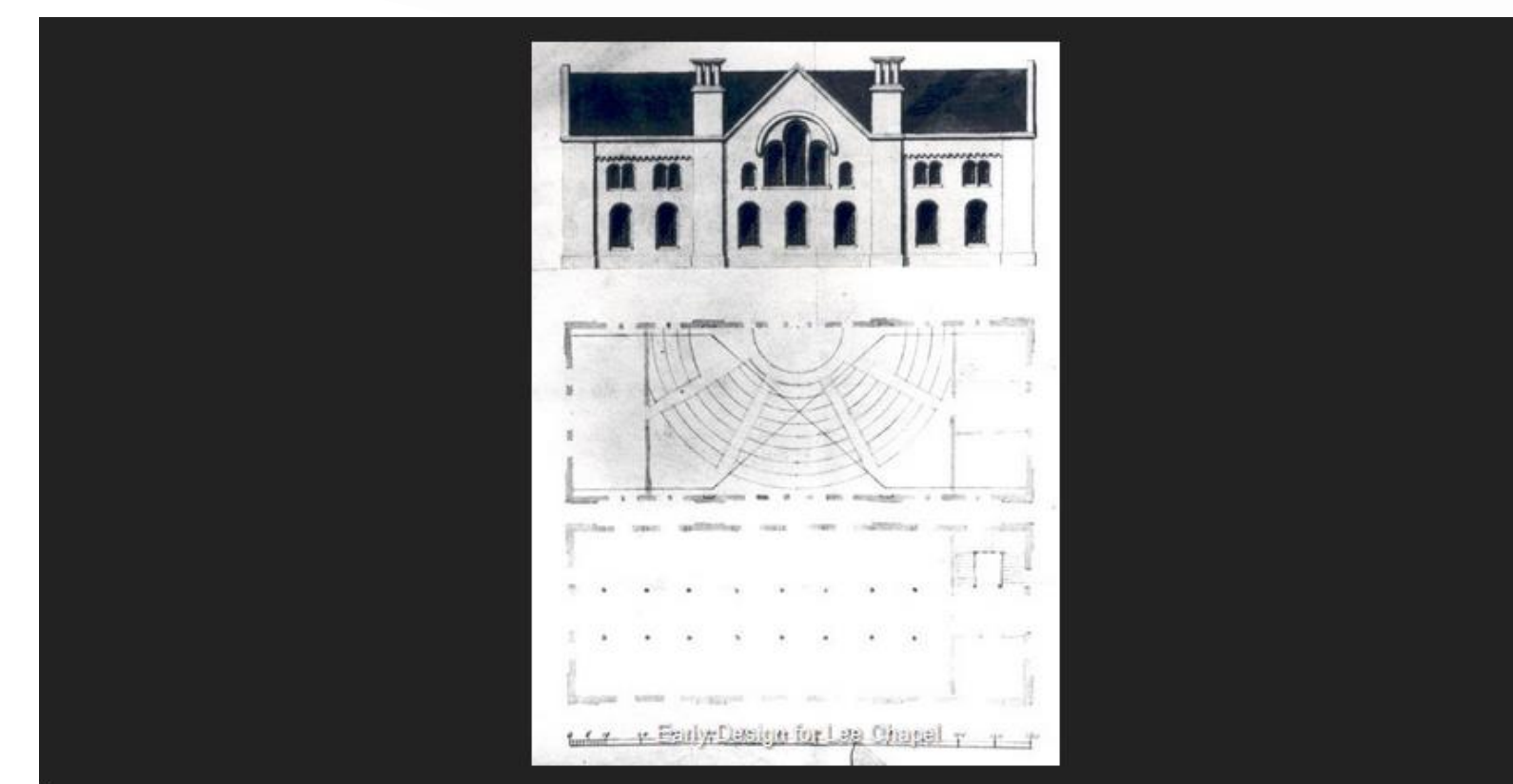
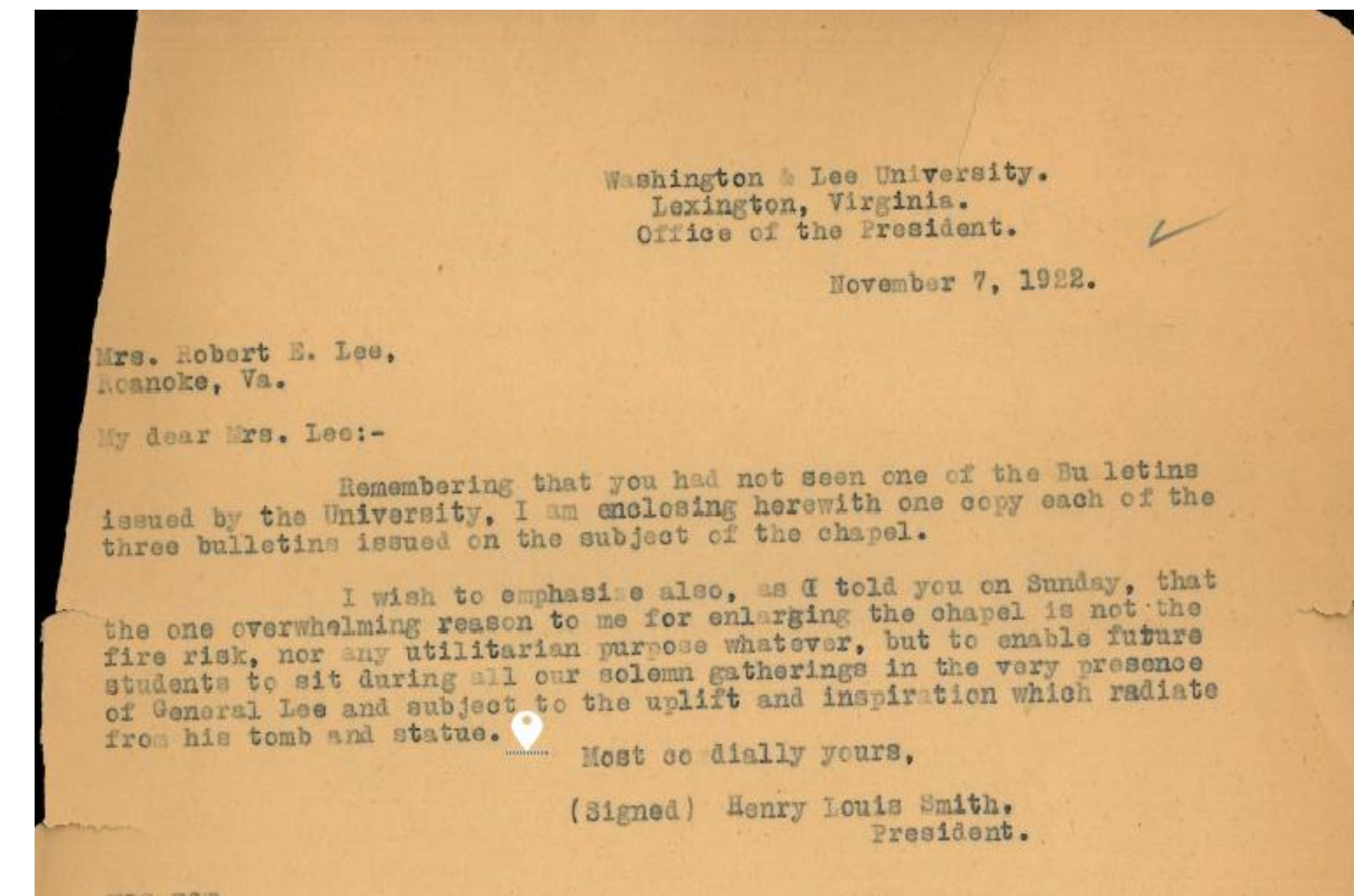

Photo gallery



Letter from Henry Louis Smith to Robert E. Lee's family

## Results and Analysis

The Chapel's original purpose –

- Religious services
- Meeting place for the student body
- Student Center

After Lee's death –

- Memorial or a shrine to Lee
  - Mausoleum
  - Recumbent statue

The proposal was rejected because the Daughters of the Confederacy felt the Chapel represented Lee's last contributions and should be preserved

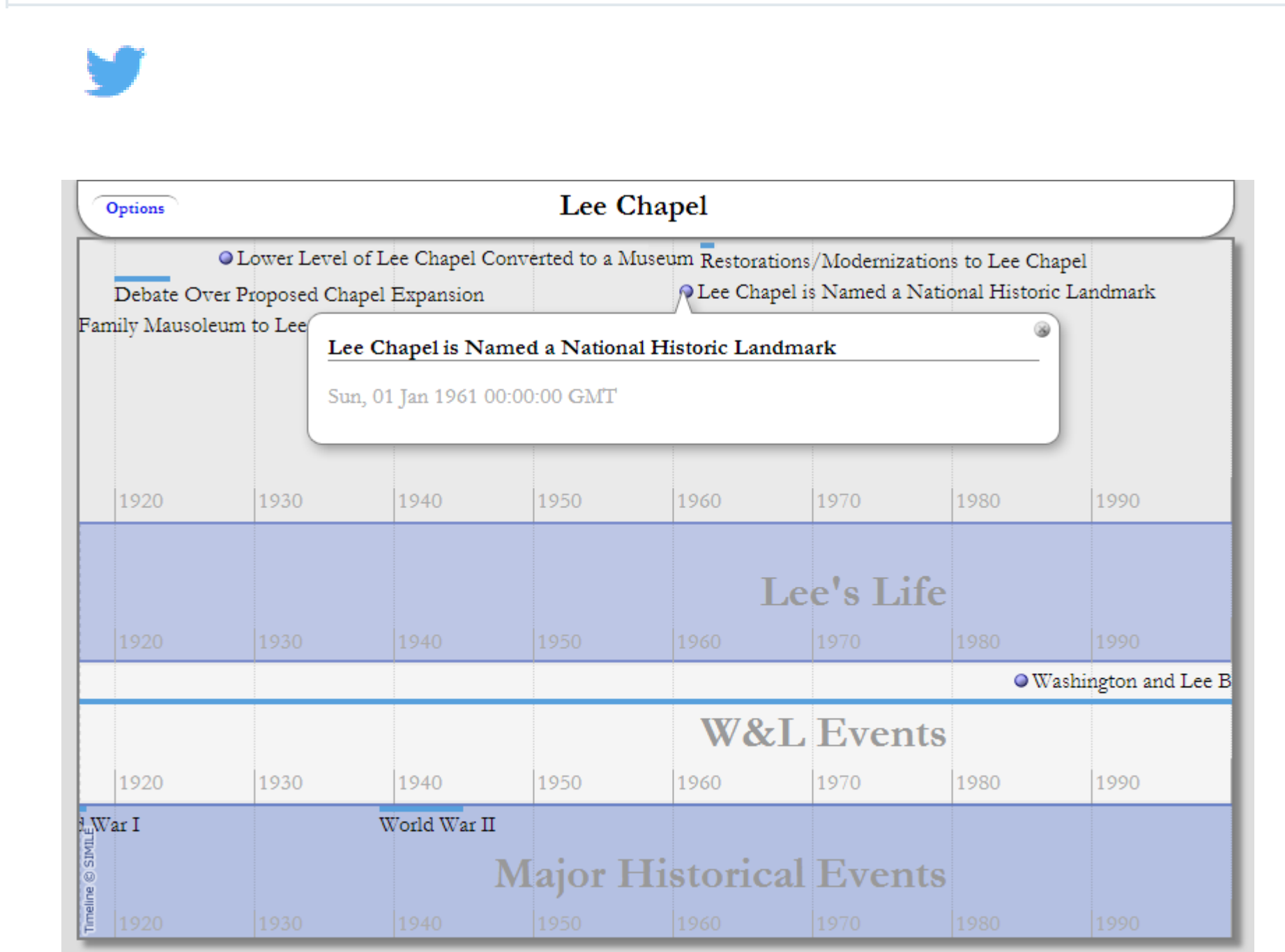
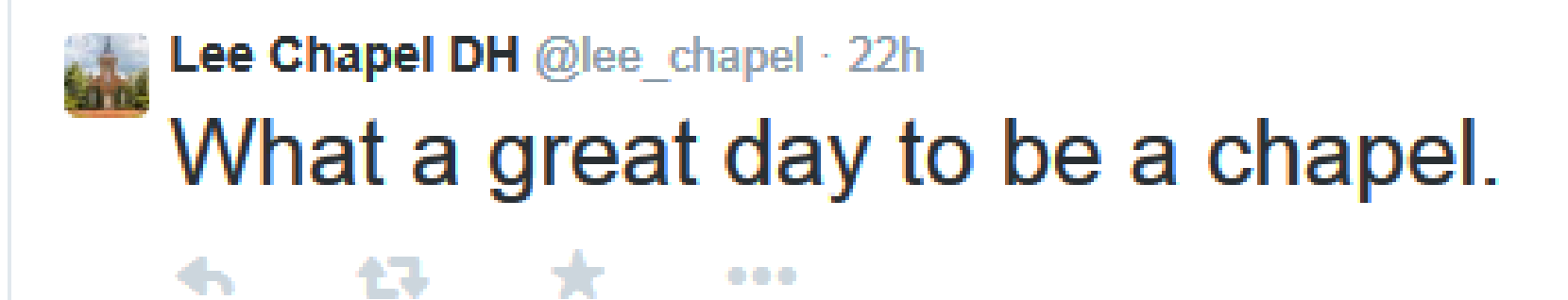

Timeline